

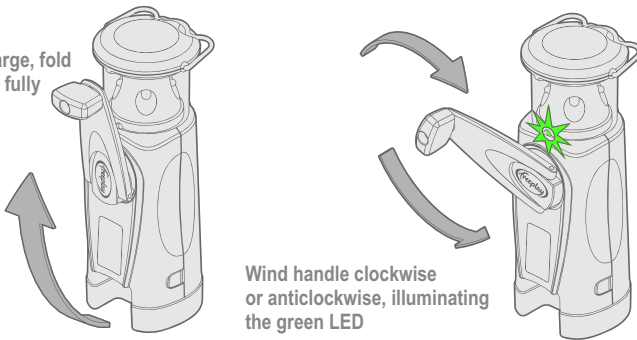

To self-charge, fold handle out fully



Wind handle clockwise or anticlockwise, illuminating the green LED

The Freeplay ML-1 Eco-Charge LED Lantern, incorporating Freeplay's self-sufficient energy technology, is a compact, lightweight and dependable lantern on the market - providing clean and convenient light anytime, anywhere.

English

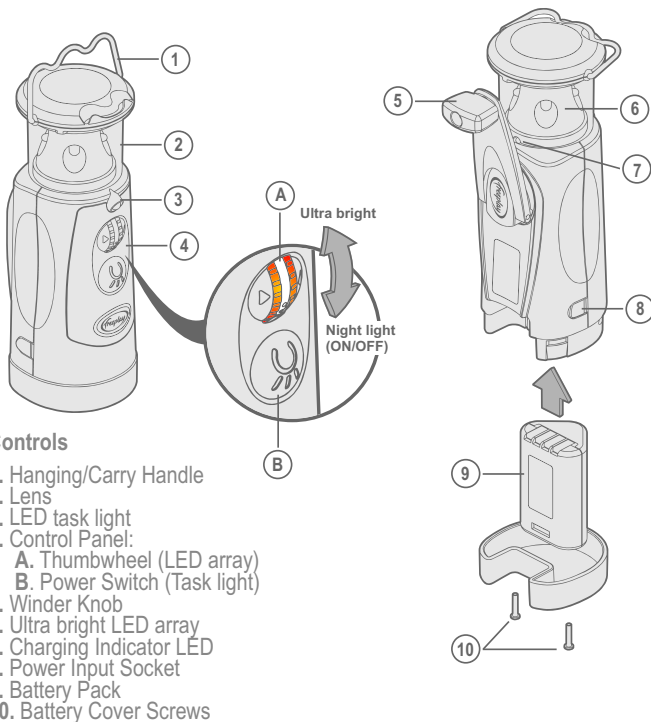

Controls

1. Hanging/Carry Handle
2. Lens
3. LED task light
4. Control Panel:
 - A. Thumbwheel (LED array)
 - B. Power Switch (Task light)
5. Winder Knob
6. Ultra bright LED array
7. Charging Indicator LED
8. Power Input Socket
9. Battery Pack
10. Battery Cover Screws

Congratulations on purchasing the Freeplay ML-1 Eco-Charge LED lantern

Please read these operating instructions carefully before using your lantern and retain them for easy reference. Record the serial number, to be quoted when dealing with Freeplay or a recognized Freeplay distributor regarding this product:

Serial number: _____

FEATURES

- Light weight (300 grams with battery)
- 8 hours of Bright light shine time on full charge
- Ultra fast charge via AC/DC, 90% charge within 3 hours
- Up to 100 hours constant shine
- Removable, replaceable battery pack
- Nichia LEDs
- Energy efficiency meter
- Extremely durable – built to last
- Glow-in-the-dark locator

PRECAUTIONS

To prolong battery life, always switch the flashlight off after use. A constant drain on a fully discharged battery will shorten the battery life. Do not open the casing, other than when removing or replacing the battery pack. Do not crank the lantern without the battery pack inserted. When cleaning, do not use abrasives or chemicals. Only use a damp cloth and mild detergents.

OPERATION

External Charging

To charge from a wall socket, switch the lantern off. Plug the wall charger into the Power Input Socket (8). The green LED (7) above the crank handle will illuminate, indicating a rapid charge. After approx. 3-hours the lantern will be 90% charged. The charge indicator will then flash, indicating that the charge rate has decreased to a constant trickle charge for the balance of the charge cycle. The adapter can remain safely plugged in while providing this continuous trickle charge. The battery will be fully charged in 8 hours from.

Self-charge Operation

To operate, hold the lantern firmly and crank the winder handle in either direction, making sure that you are cranking fast enough to illuminate the Charging Indicator LED (7) constantly. A self-charge of about 1 minute will provide up to 60 minutes of night light. The lantern can be cranked further at any time to extend shine times. Cranking the winder handle drives the internal alternator via a transmission, generating self-powered energy which is stored in the internal battery.

Internal battery

For best results, the internal battery requires a conditioning charge for 8 hours prior to first use. The lantern can, however, be used immediately in the "self-charge mode" if required.

Light Options

The ML-1 has 2 light options: A space illuminating 4 LED array and an LED task light

The brightness of the 4 LED array is controlled by a dimmer switch and can be adjusted using the thumbwheel control (4A) to give you the option of selecting any brightness - from night light to ultra bright. This unique feature lets you match your lighting requirements to your specific application, maximizing your energy efficiency.

An energy efficiency meter is incorporated into the thumbwheel. As you rotate the thumbwheel, the switch will illuminate to indicate the efficiency of the light setting selected. Green indicates a low energy usage and a prolonged total shine time. Red indicates a high energy use and a shorter total shine time.

A glow-in-the-dark band around the thumbwheel helps to help locate the lantern in the dark.

The directional Task Light LED has a fixed brightness, and is independently controlled by the power switch below the dimmer switch (4B). This LED can also be used while the LED array is on. The downward angle of the LED makes it an ideal task light for illuminating specific areas for reading or working, and can also be used as a handy flashlight.

Replacing the Battery Pack

Spare battery packs can be carried with the lantern to conveniently extend shine times when you are away from grid access for prolonged periods. To replace the battery pack, remove the 2 battery cover screws (10) at the base of the ML-1. Remove the cover, exposing the battery pack. Pull the release catch, ejecting the battery. Insert a replacement battery, replace the cover and screws. Do not crank the lantern with the battery pack removed. When disposing of the unit, the battery pack should be removed first. Ni-MH batteries should be recycled or disposed of in an environmentally friendly way as prescribed by your local regulations.

SPECIFICATIONS

Power Source:

Self-charge: AC alternator driven by the crank via a transmission

Rechargeable Battery

Removable rechargeable 3.6 V Ni-MH battery pack.

Light Source:

Ultra Bright white Nichia LED array (4 LEDs)
5 mm Single Ultra Bright white Nichia LED

Adapter Charge rate:

3 hours - 90% capacity
8 hours - 100% capacity

Shine Time:

4 LED Array
Fully recharged battery - 100 hours (night light)
Fully recharged battery - 8 hours (max-bright)

60-second self-charge - 1 hour (night light)
60-second self-charge - 7 minutes (max-bright)

Single LED

Fully Charged - 40 hours
60 second self-charge - 45 minutes

Dimensions: Metric (mm) Imperial (inches)

Height	165 (6.5)	Width	56 (2.2)
Length	62 (2.5)	Weight	300g (10.5 oz)

FREEPLAY 2 YEAR WARRANTY

The manufacturer undertakes that, if within 2 (two) years of purchase, this appliance or any part thereof is proved to be defective by reason of faulty workmanship or materials, we will, at our option repair or replace the same free of charge for labour or materials on condition that:

1. The original invoice or sales receipt (indicating the date of purchase, product type and dealer's name) is presented together with the defective unit.
2. The complete unit is returned to the manufacturer or country distributor, postage paid.
3. The unit has not been serviced, maintained, repaired, taken apart or tampered with by any person not authorised by the manufacturer.
4. All service work is undertaken by the manufacturer or appointed agents.
5. Any defective unit or part shall become the property of the manufacturer.
6. This warranty is in addition to your statutory rights.